

ATTENTION

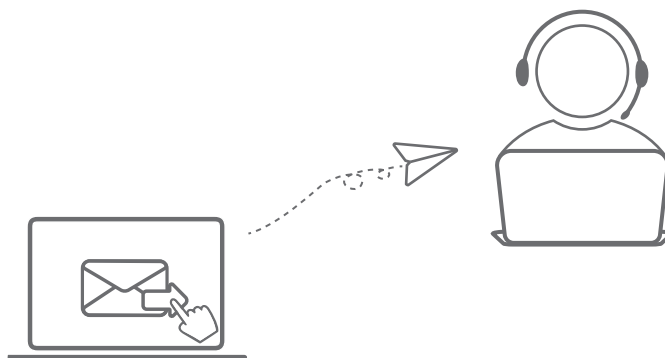

KEEP DRY

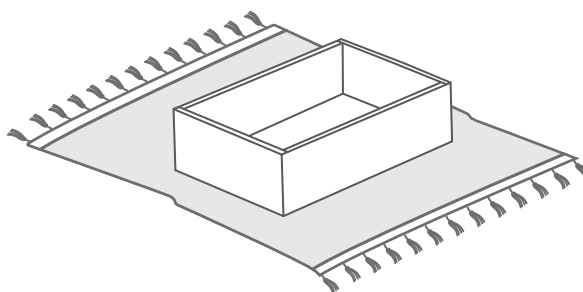
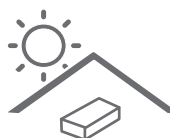

NO SUN EXPOSURE



SOFT DRY CLOTH

PARTS LIST

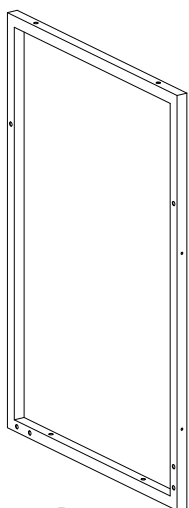

1x2

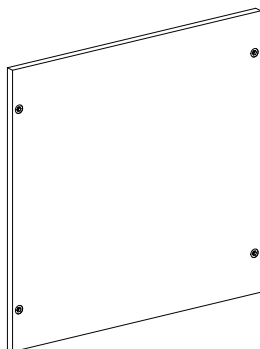

2x1

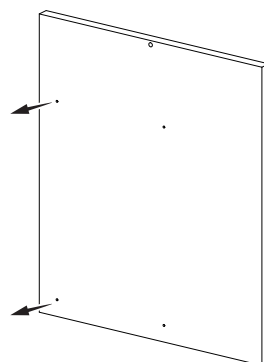

3x1

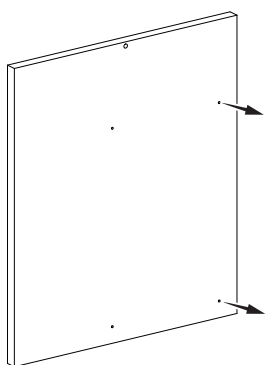

4x1

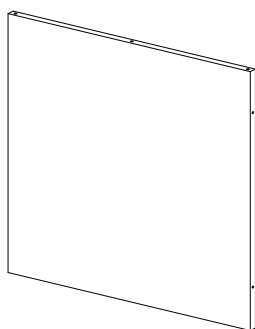

5x1



6x2

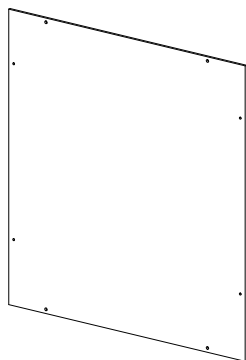

7x1

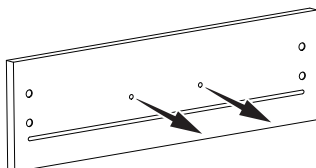

8x1

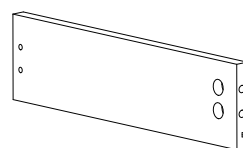

9x1

PARTS LIST

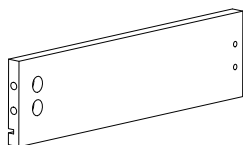

10x1

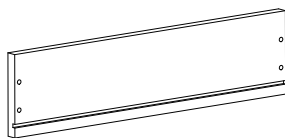

11x1

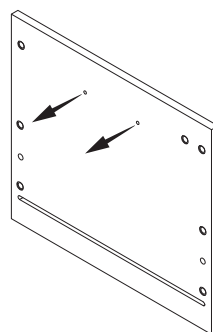

12x1

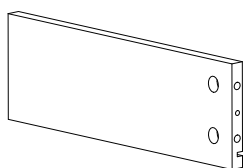

13x1

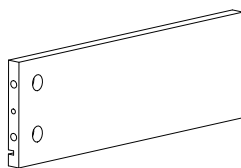

14x1

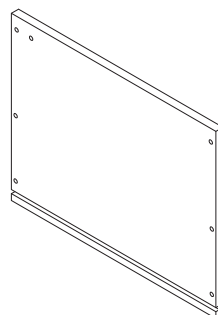

15x1

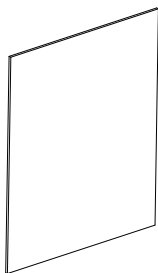

16x2

HARDWARE LIST

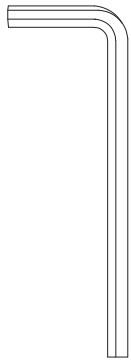

Ax1

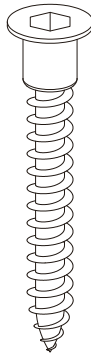

Bx26

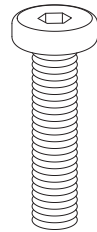

Cx4



D1



D2

Dx8

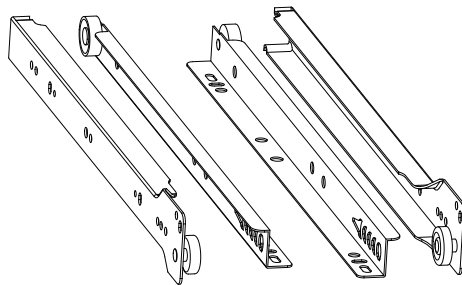

CL

DL

DR

CR

Ex2



Fx2

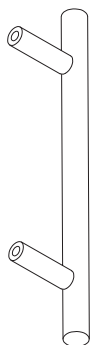

G1x1

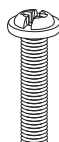

G2x2

Gx2

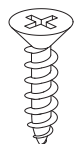

12mm

Hx24



Ix2

HARDWARE LIST

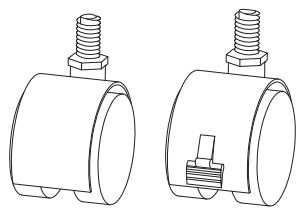

J1 J2

Jx2

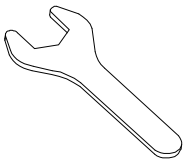

Kx1

1 ATTENTION

During assembly, first loosely align all screws with the corresponding pre-drilled holes and then tighten the screws one by one.

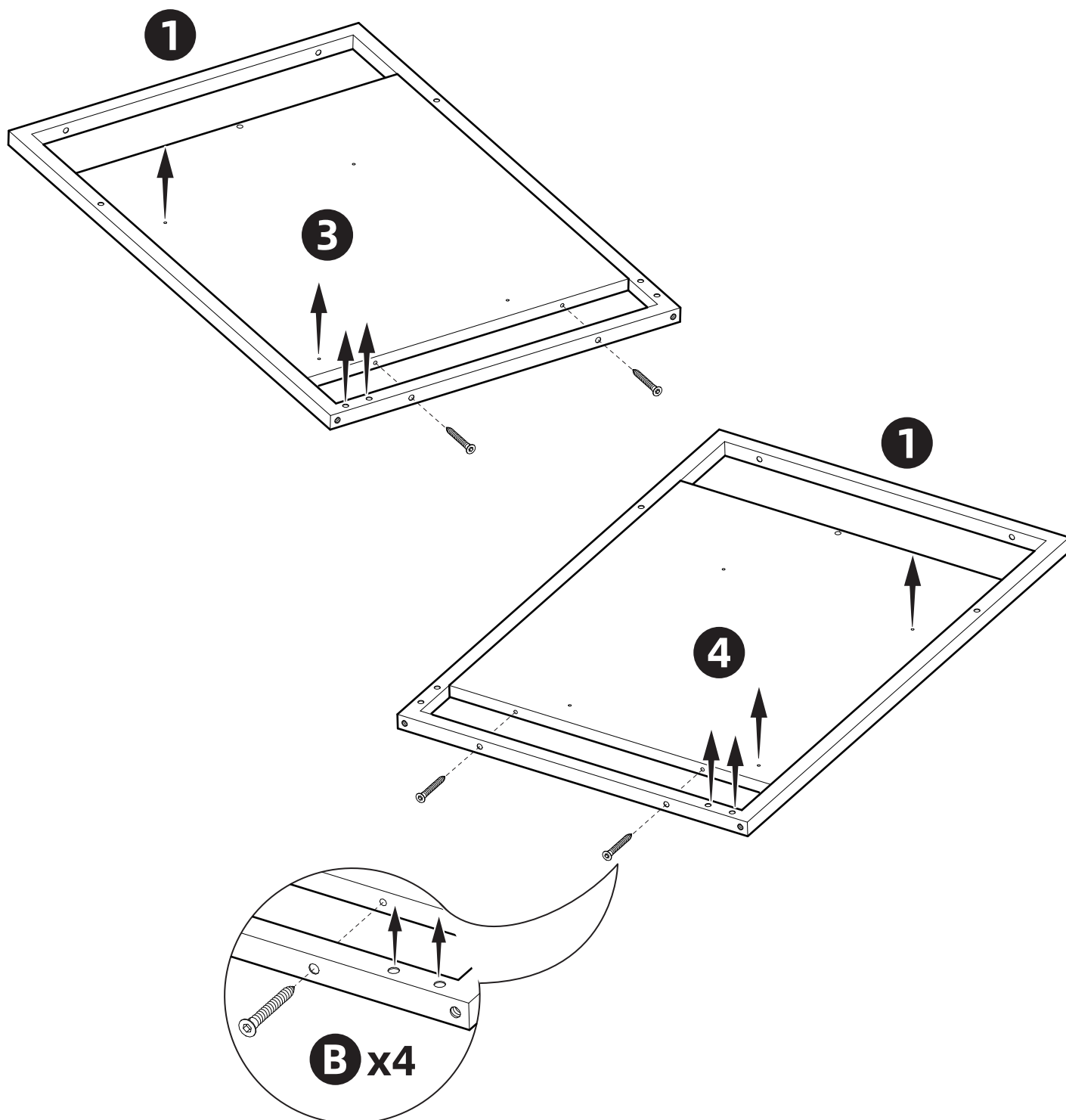

2 ATTENTION

Please note the direction of the holes .

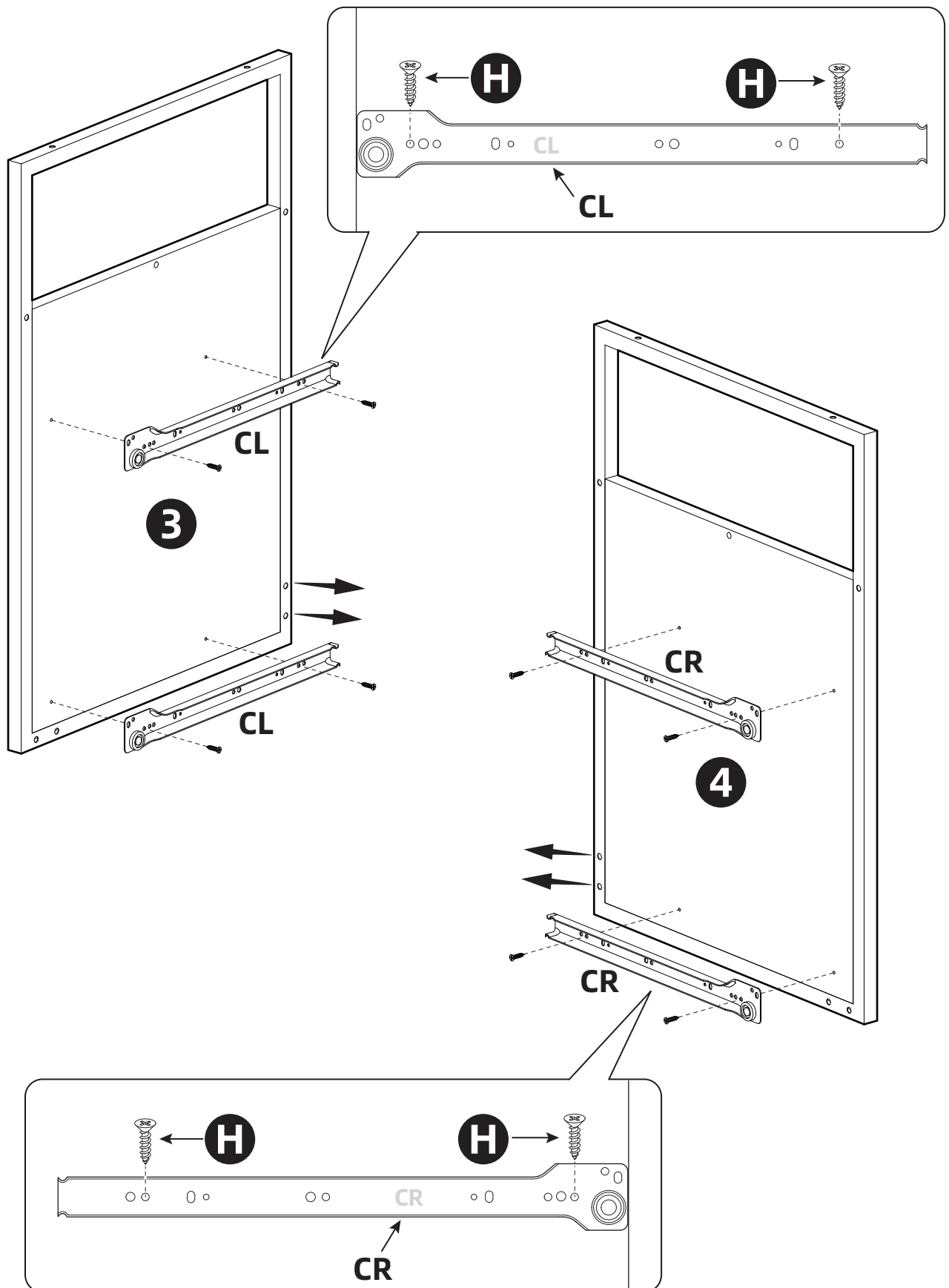

3 ATTENTION

Please note the direction of the holes .

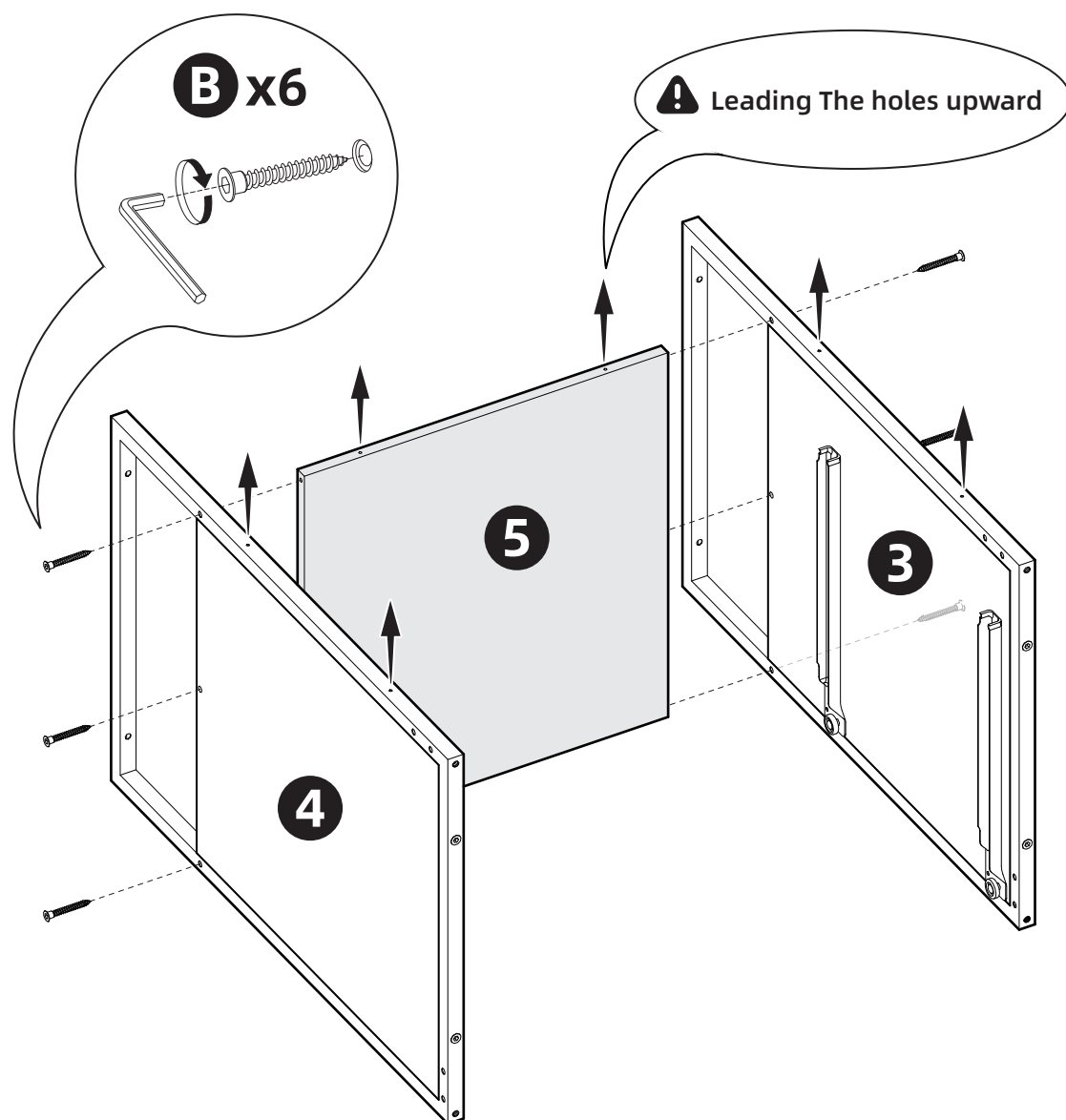

4

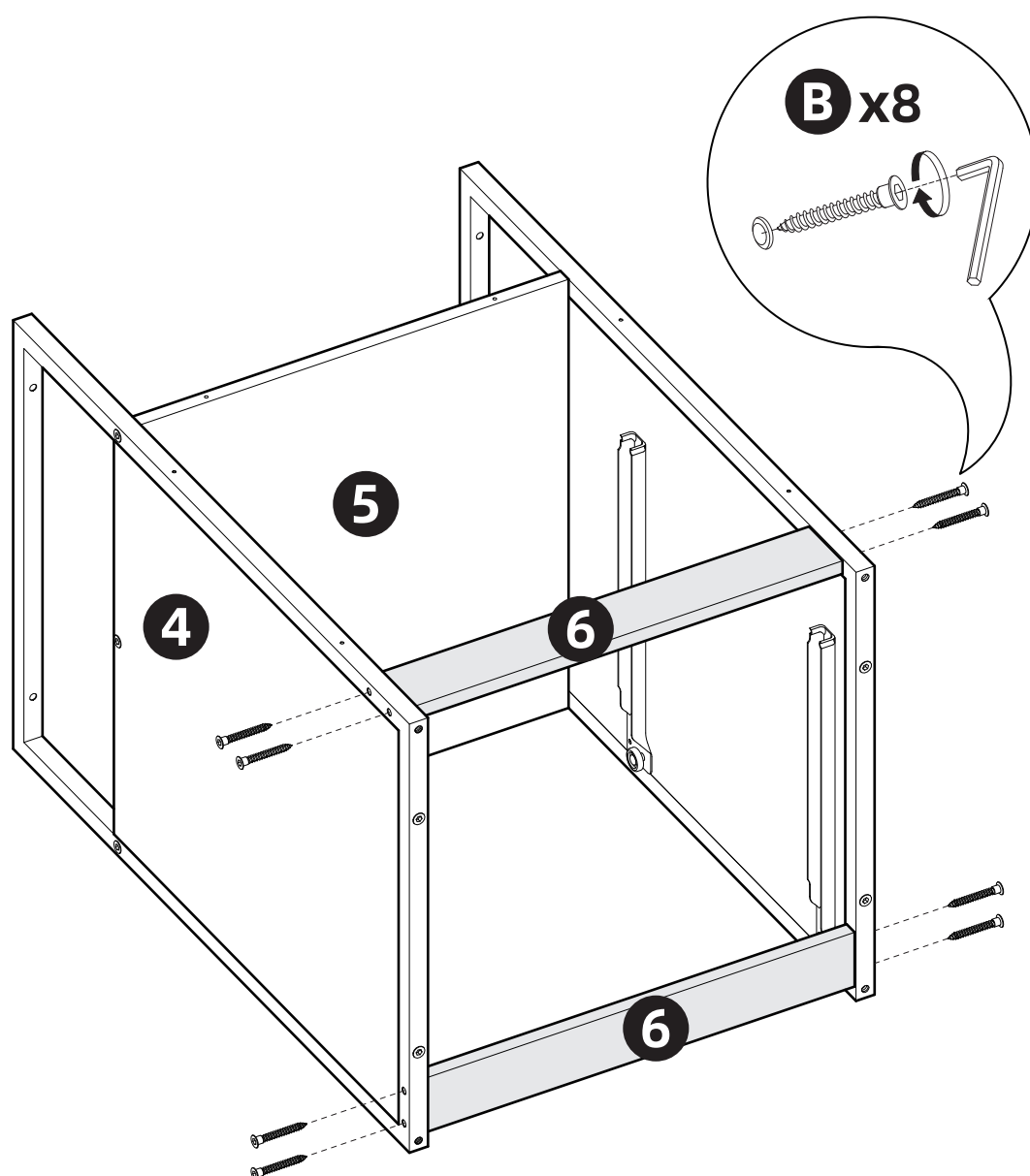

5

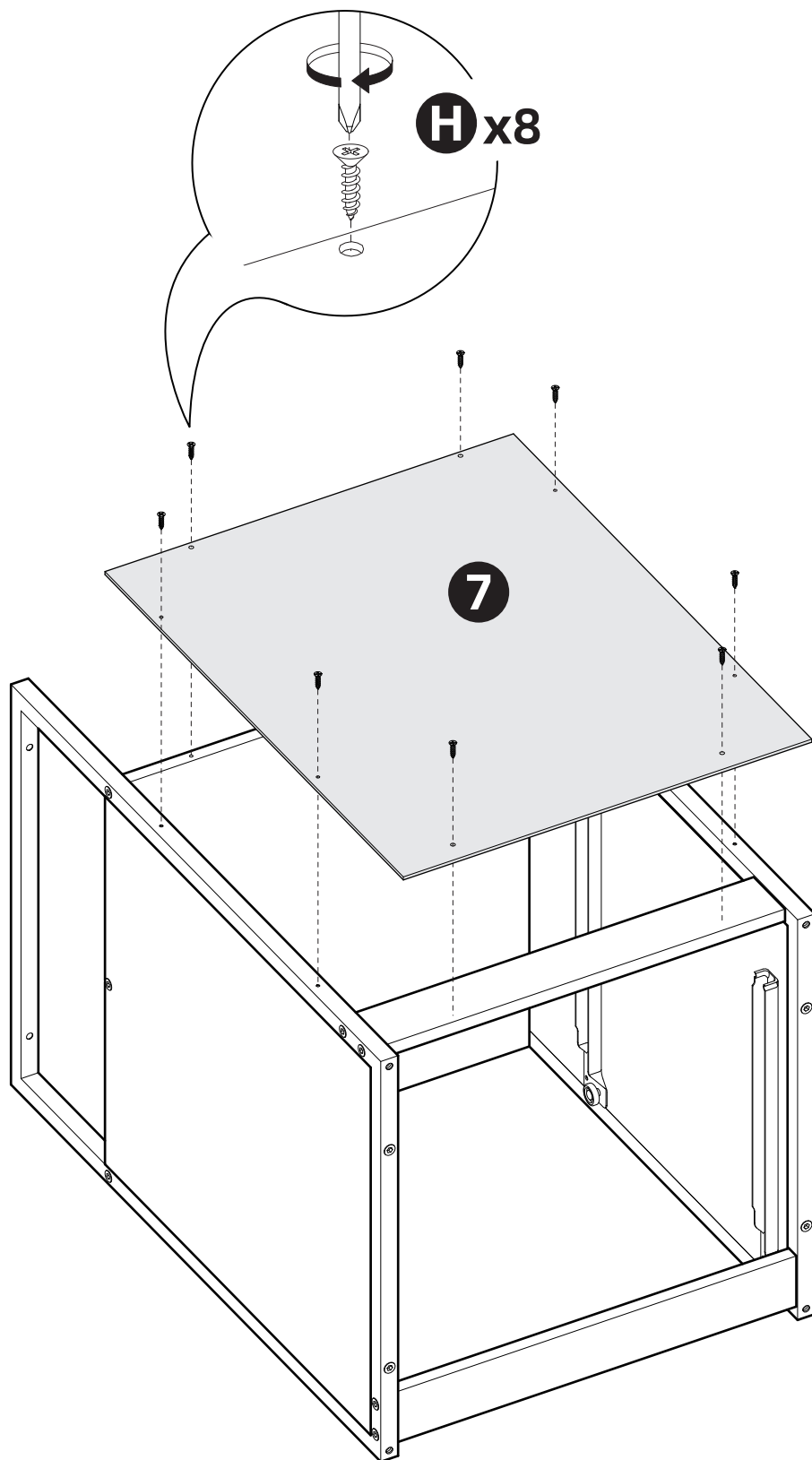

6

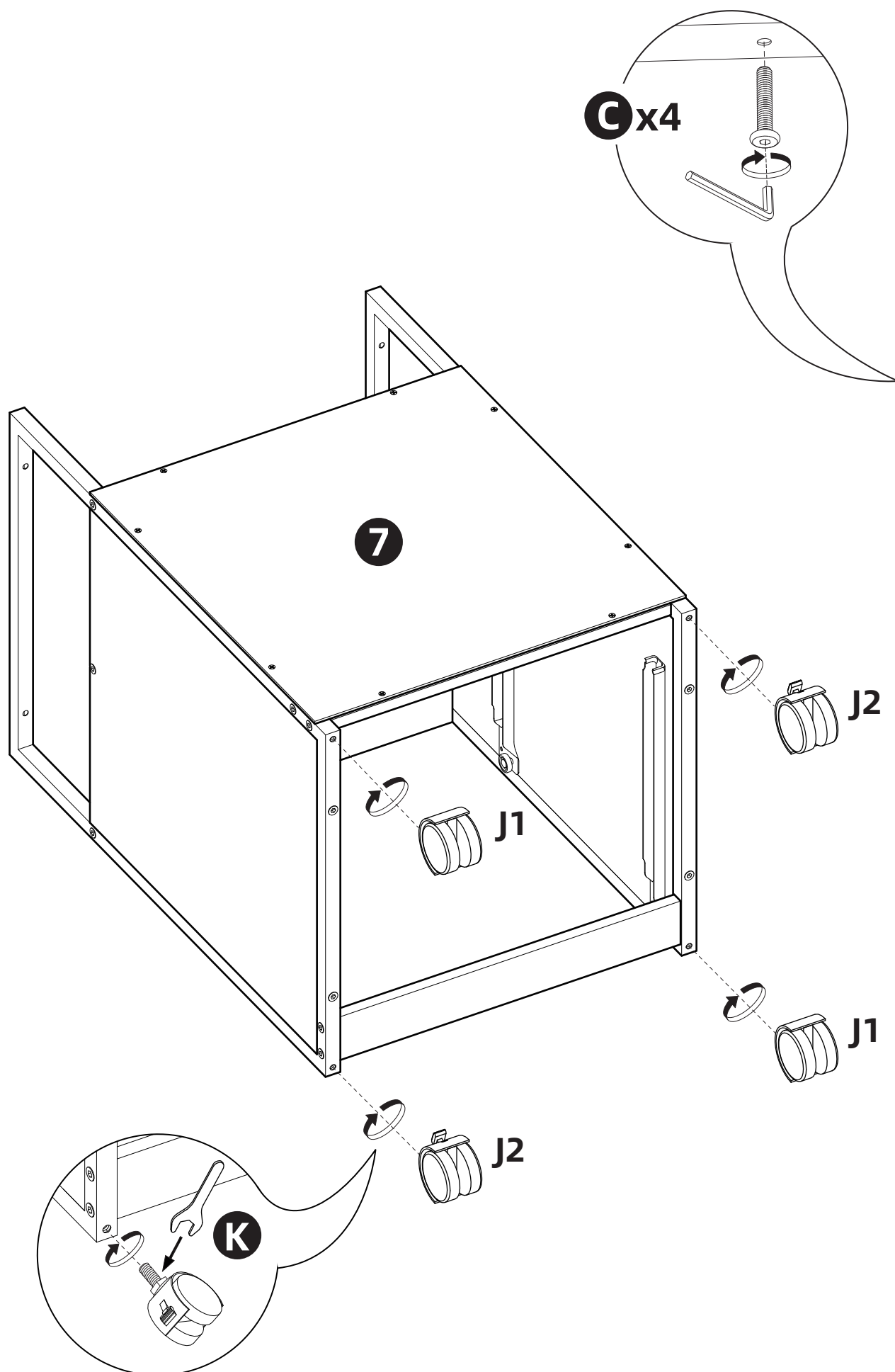

7

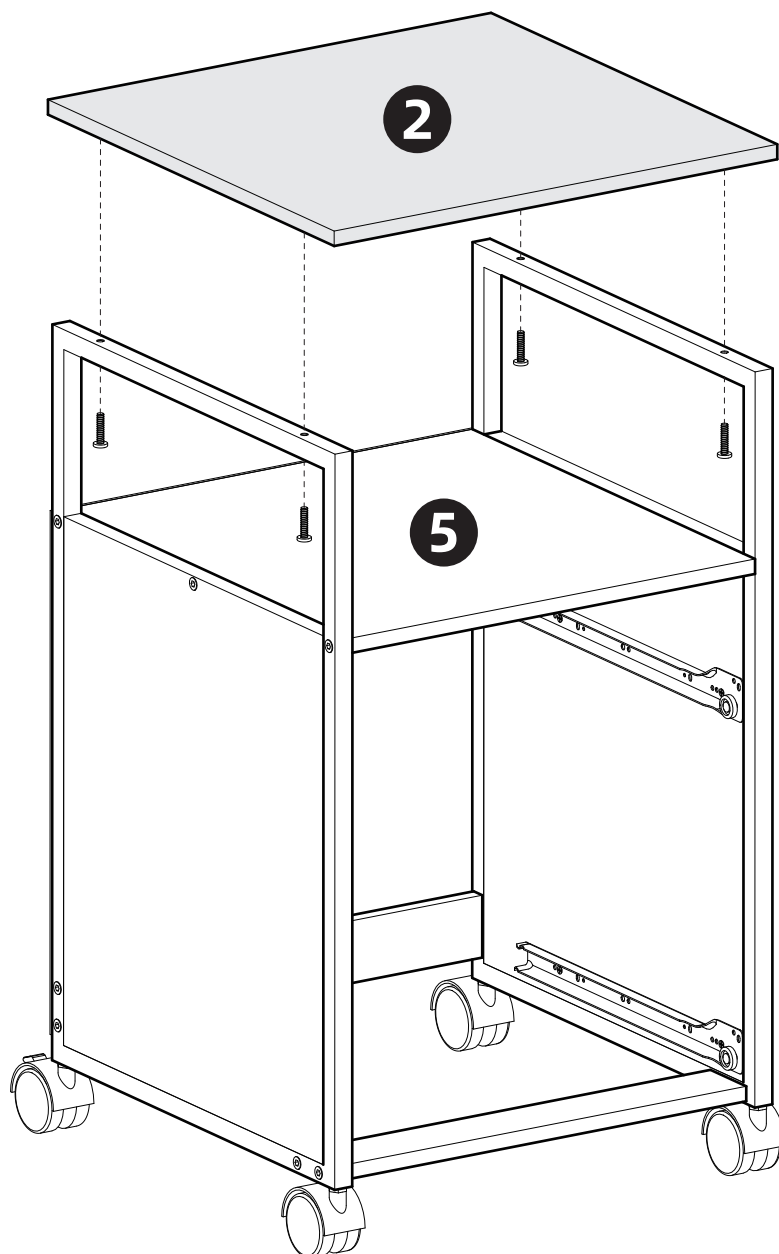
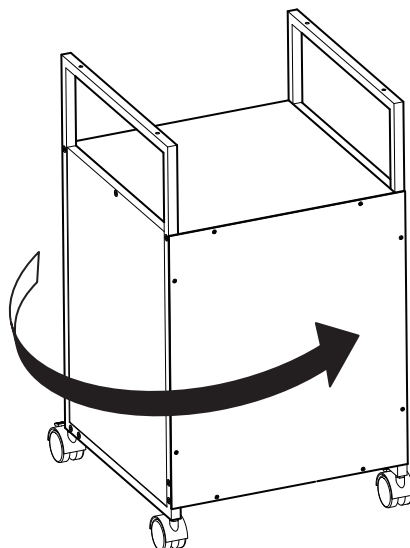

8

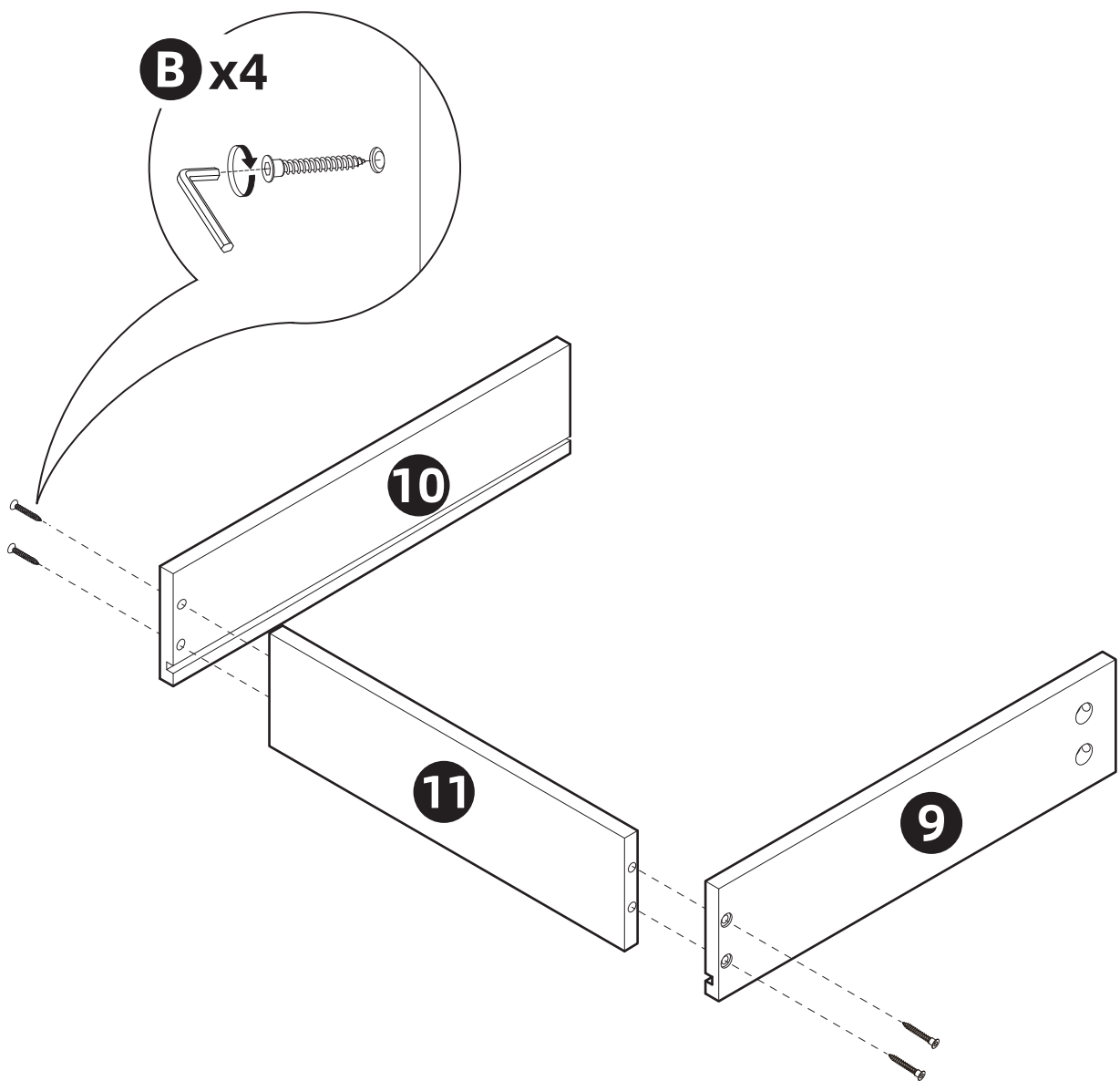
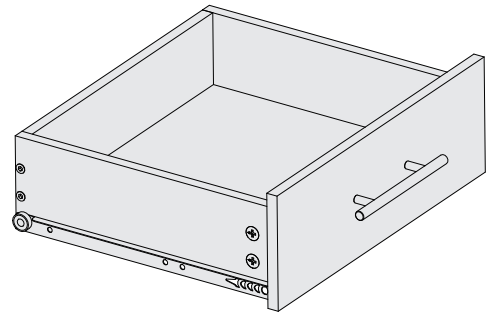

9

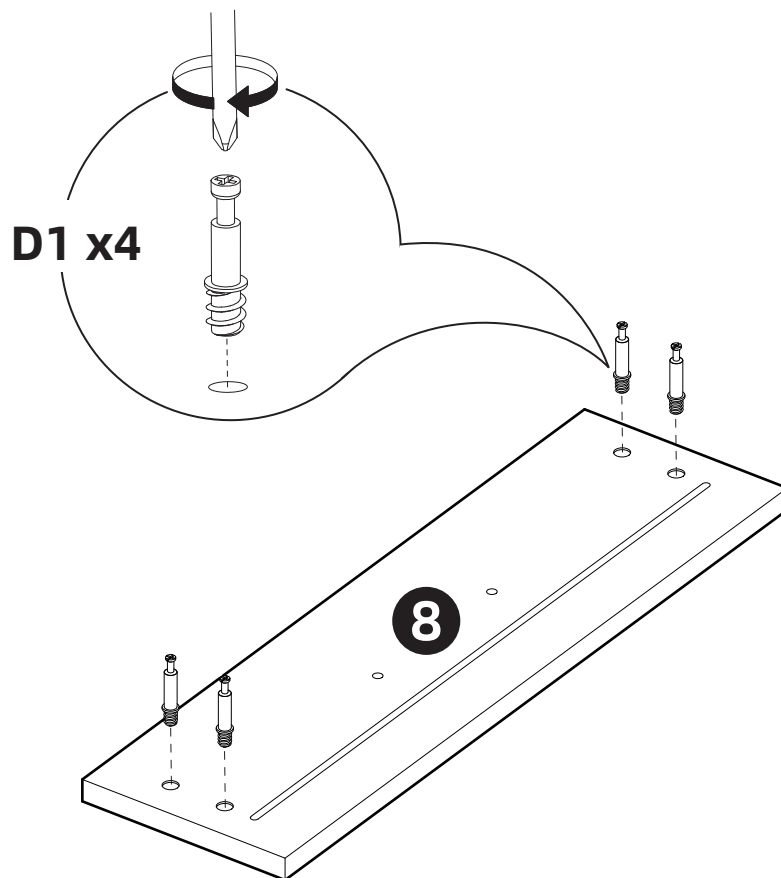
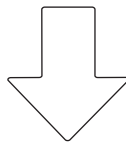
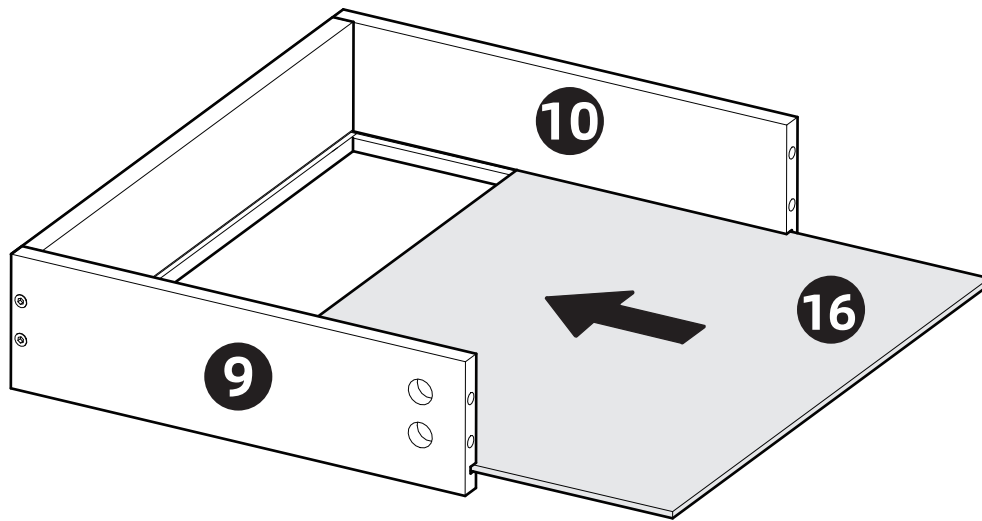

10

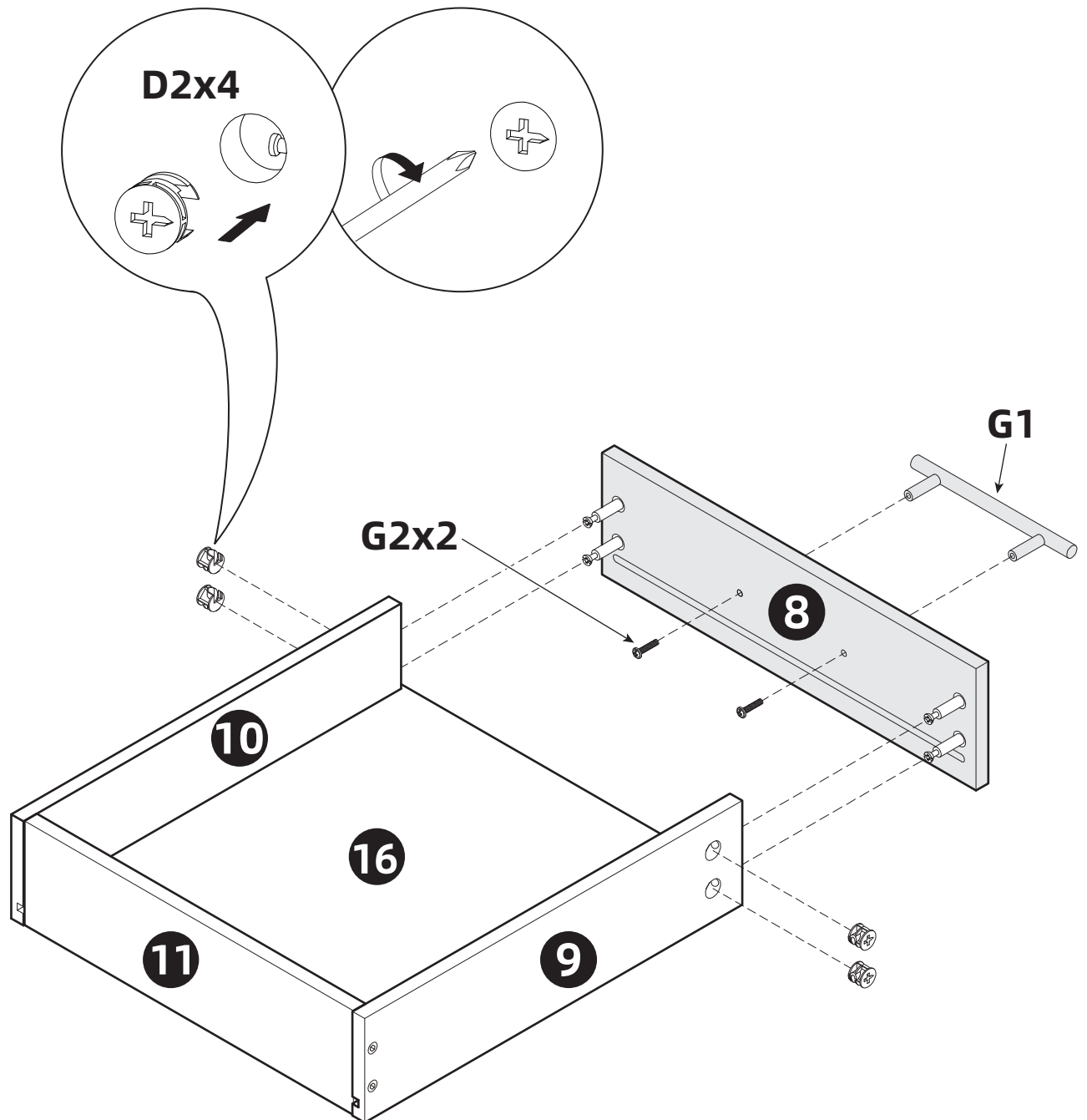

11

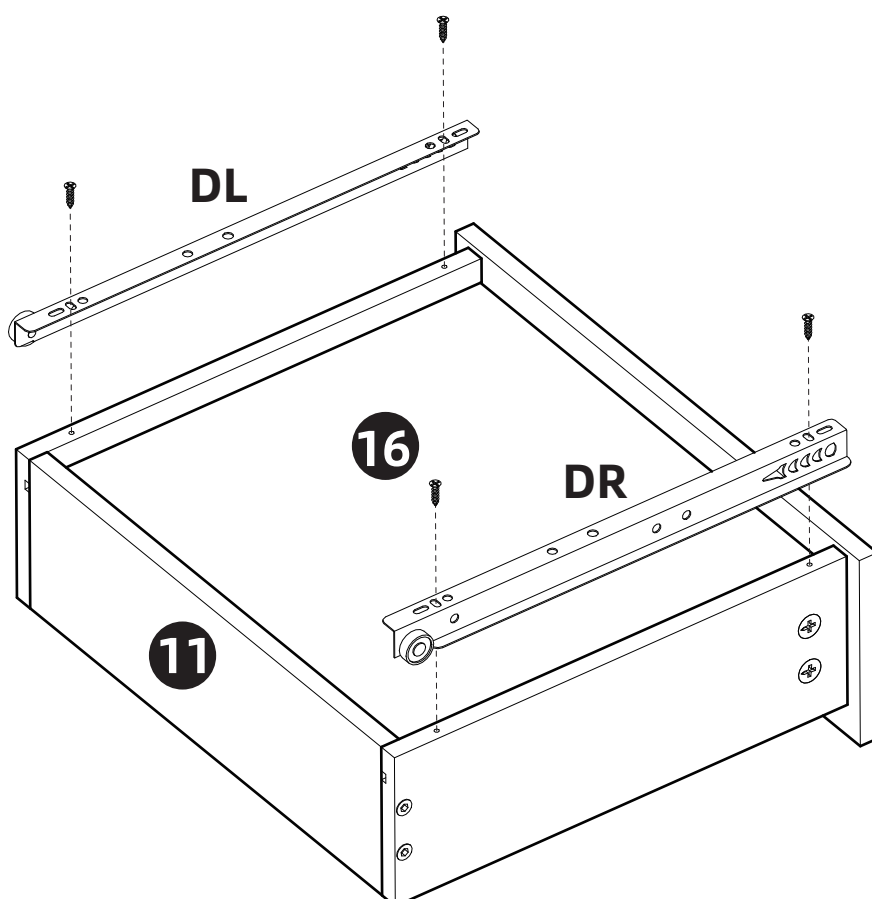
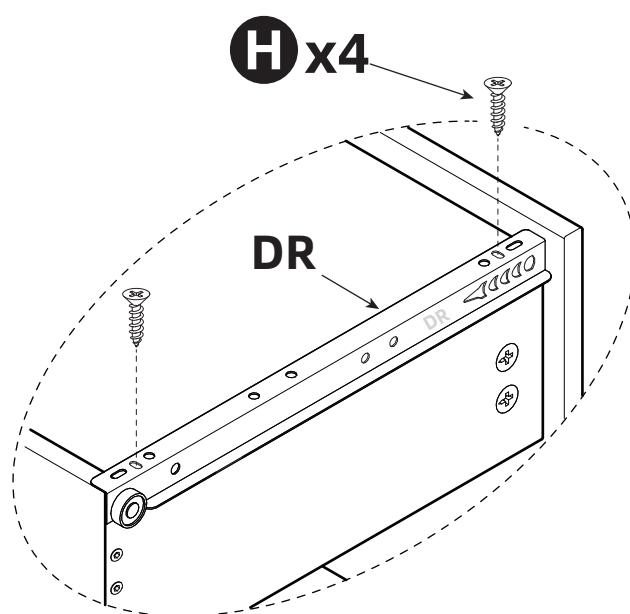

12

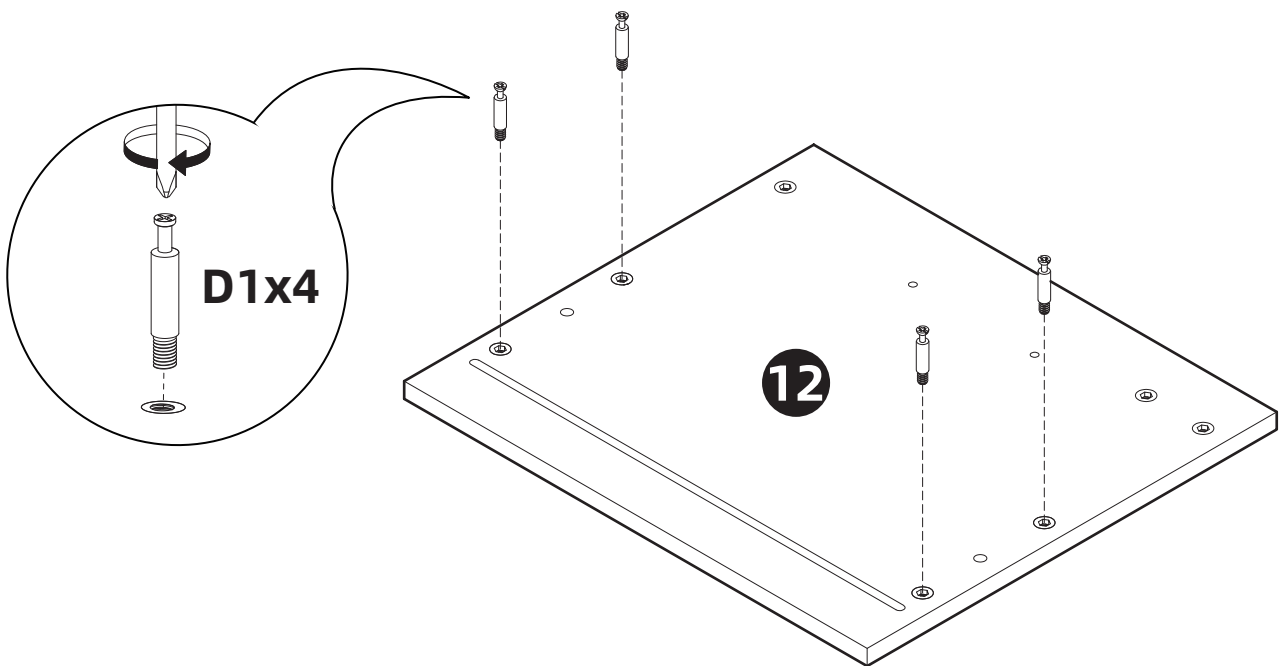
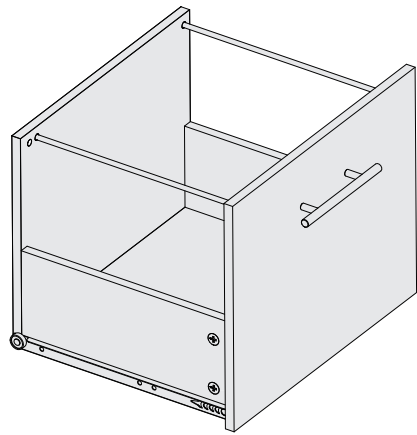

13

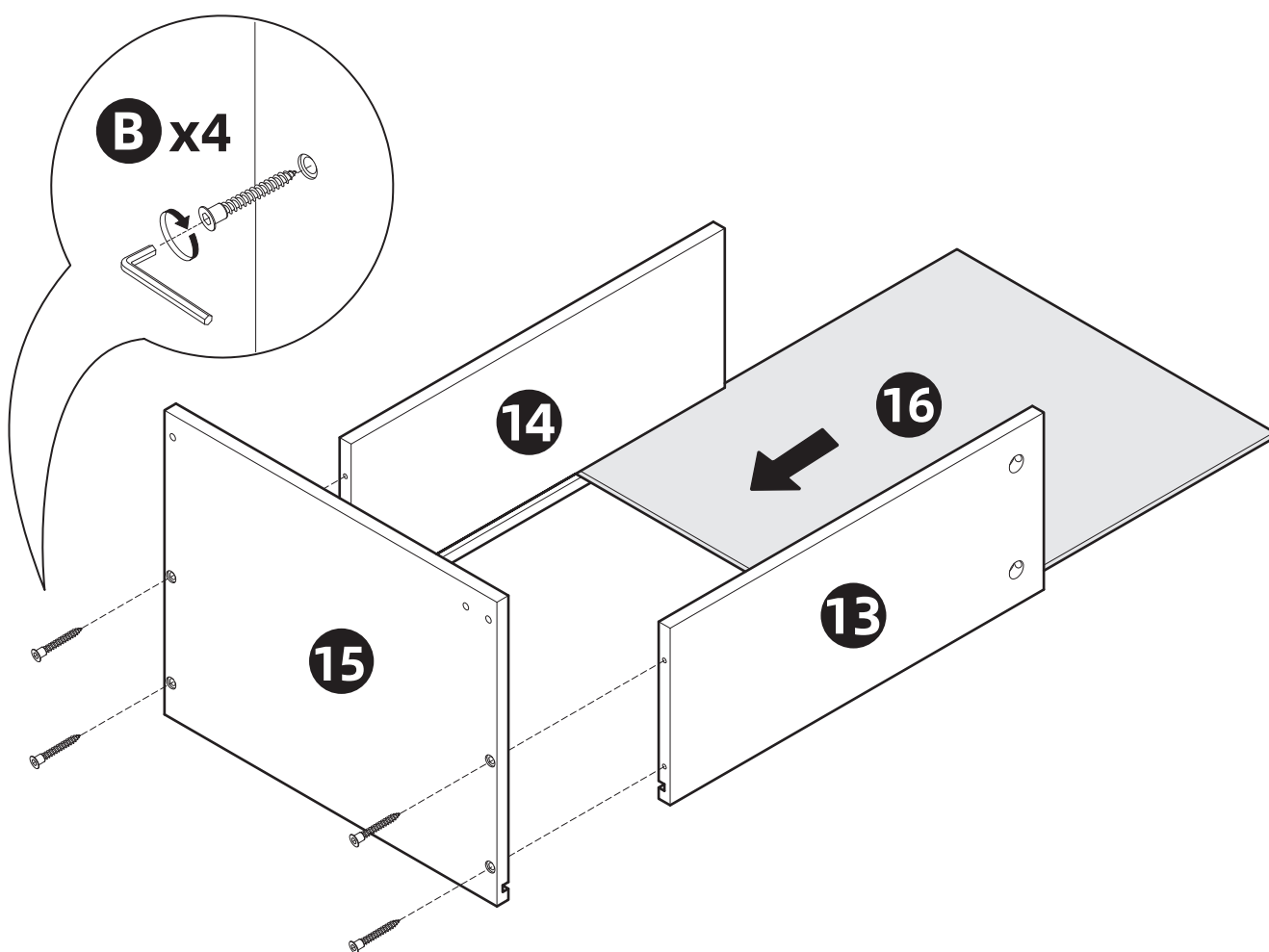

14

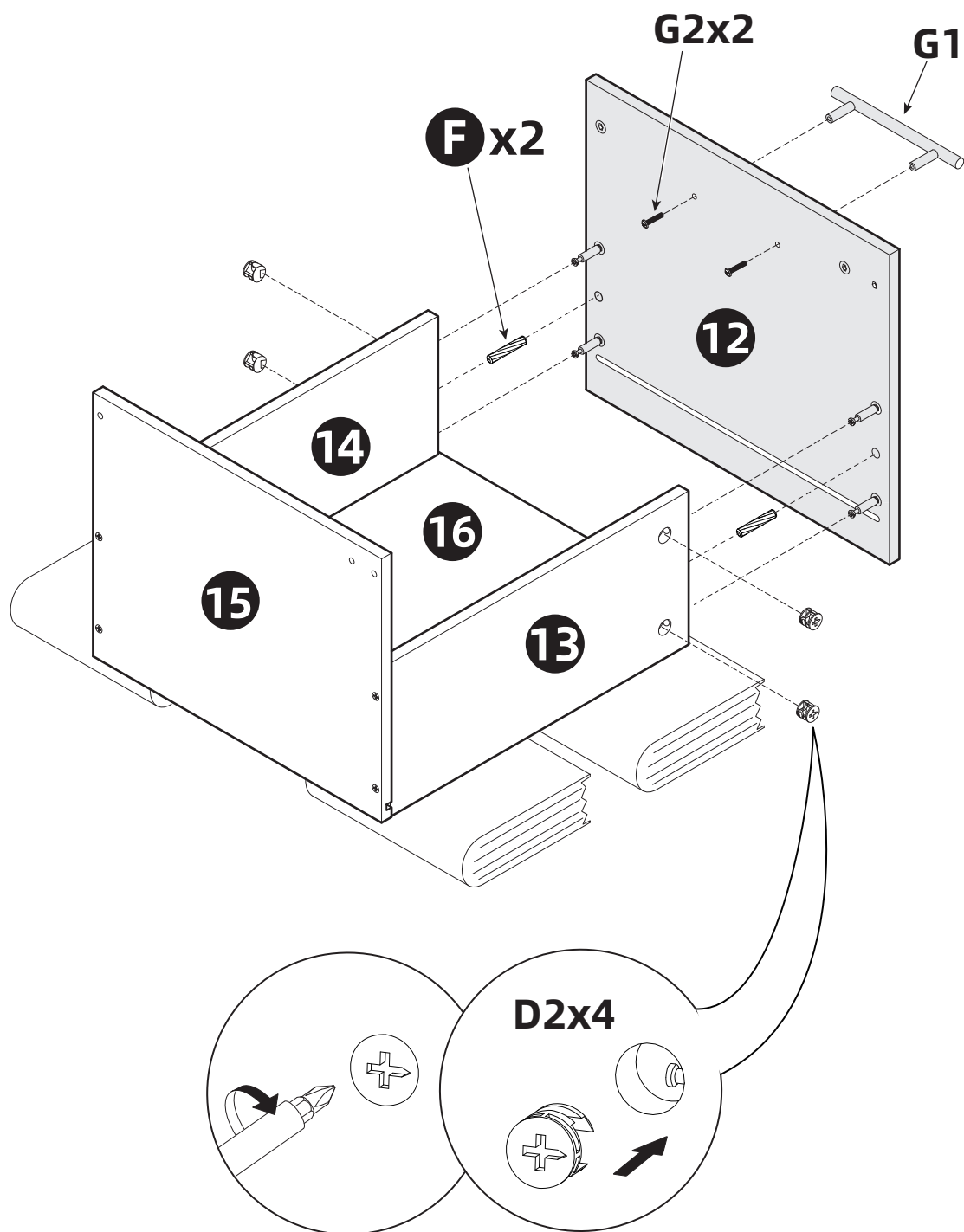

15

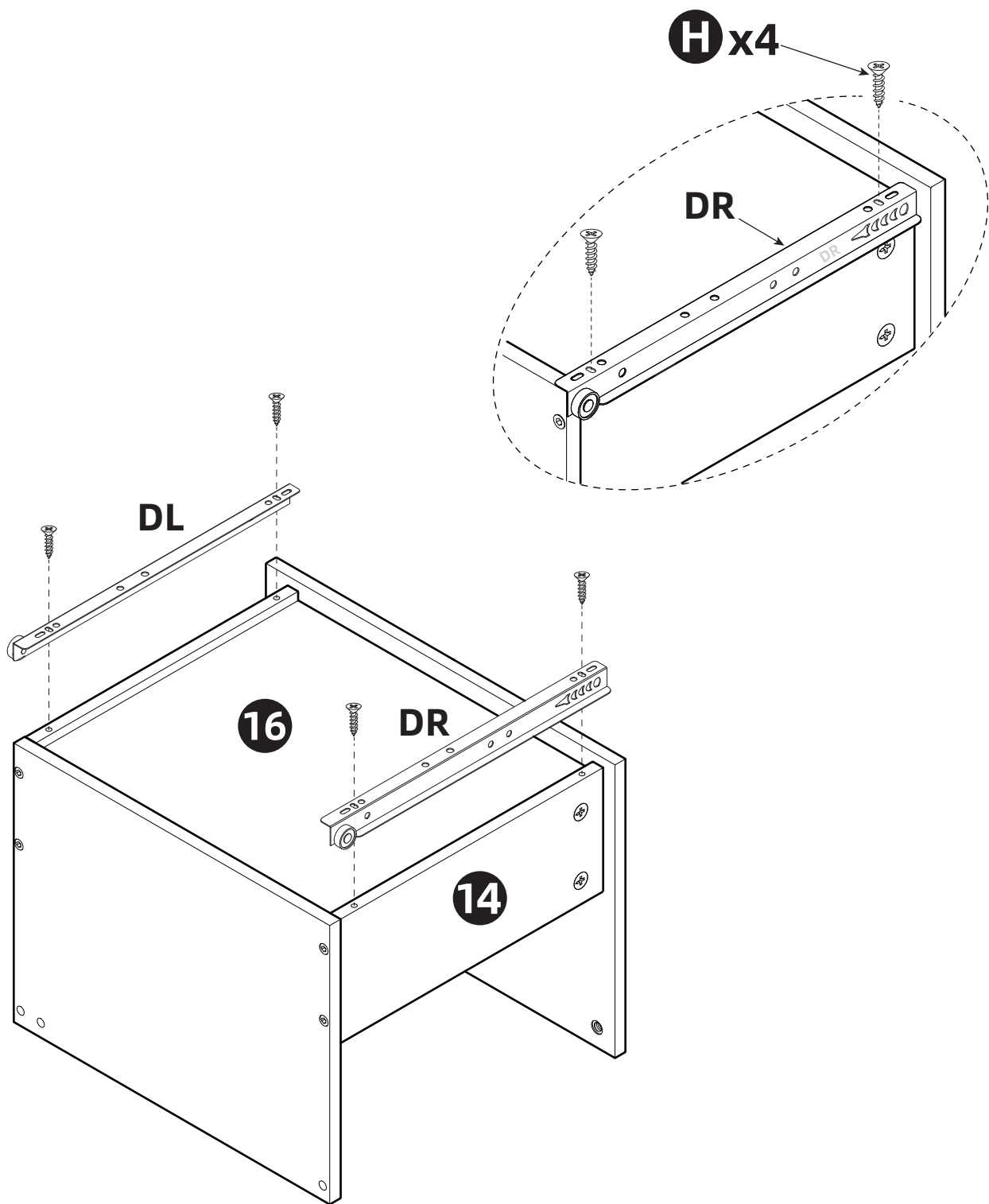

16

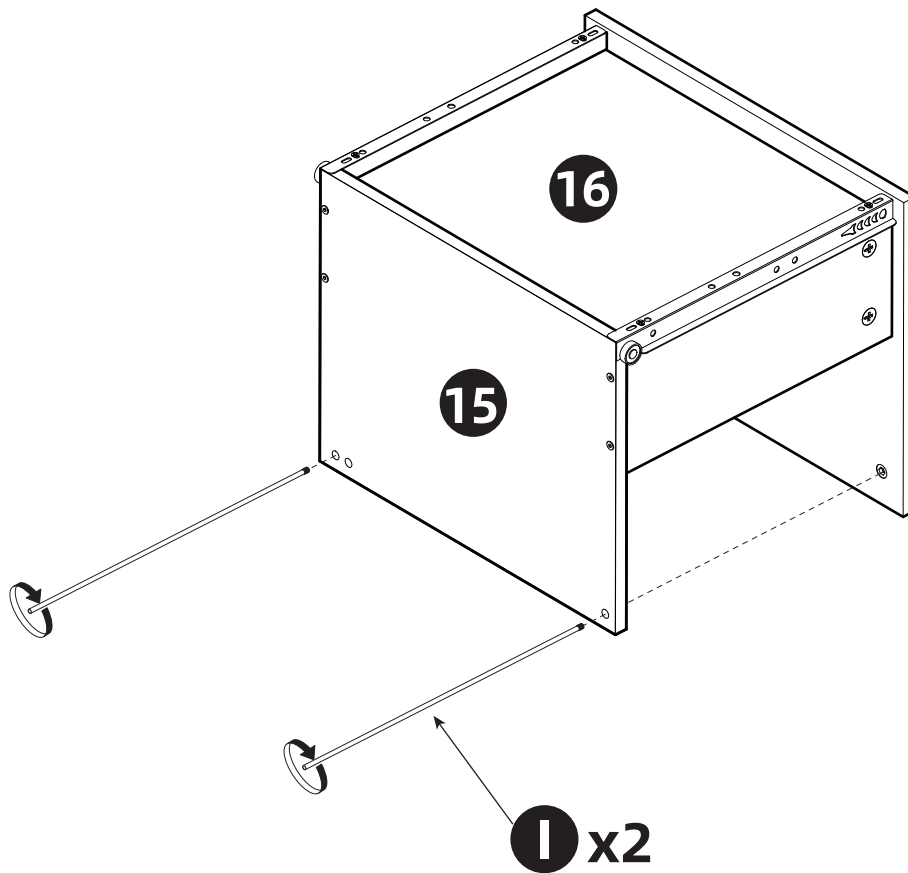
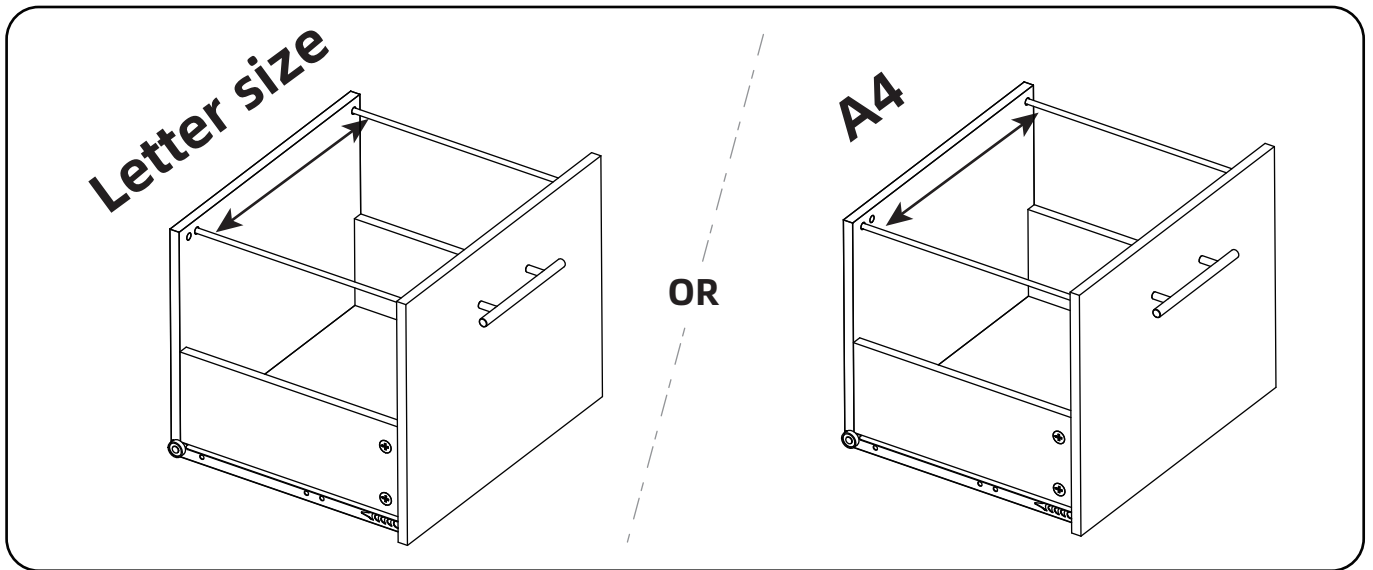

17

