

"I loooove spending hours assembling furniture."

- nobody, ever.

Welcome to the future of furniture, where you can say goodbye to those nerve-wracking questions like "where does that part go?" or "how do I use this tool?" Time is money people, let's make this snappy! Scan the QR code or follow the instructions to below. Buckle up, amigos, 'cause you're about to be Hoek'ed!

Larry the Leg, Chief Furniture Office (CFO)

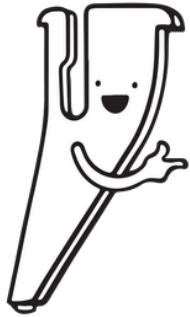

DESK ASSEMBLY

1. Unclip leg from the top by spreading the plastic tooth and leg apart, then lift upwards.

KEEP TABLE IN BOX UNTIL ASSEMBLED

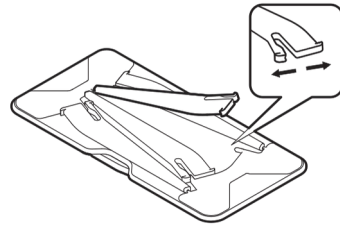

2. Insert leg with plastic tooth facing outward. Pull leg to click into place.

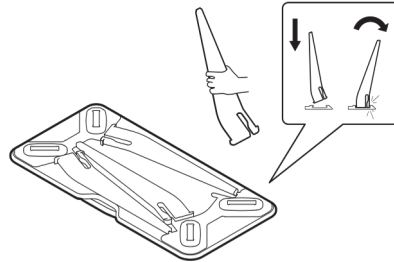

3. Repeat steps 1 & 2 for other legs. Now you're ready to flip your desk over!

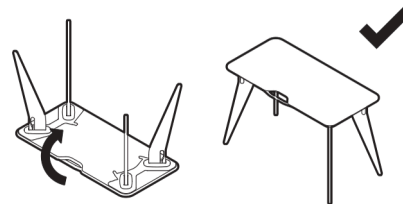

SHELF ASSEMBLY

1. Insert the riser leg into the shelf. Repeat that step for the other riser leg.

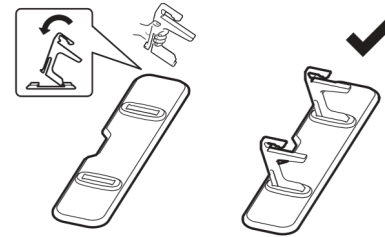

2. Click the shelf assembly onto the rear of the desk (handle side).

Side View

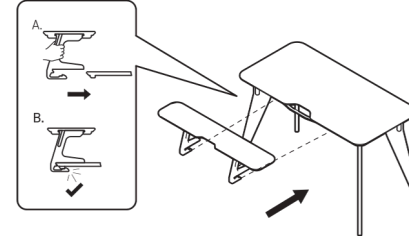

3. Now your monitor shelf is all set!

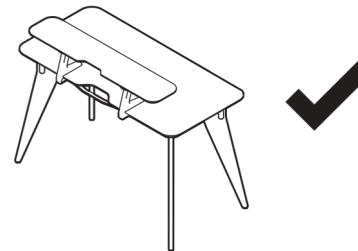

UNDERSHELF ASSEMBLY

1. Align each arm with the two slots on each side of the undershelf (beveled edge down).

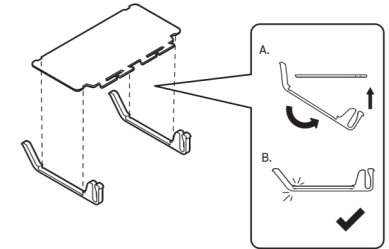

2. Press each arm to click onto the undershelf.

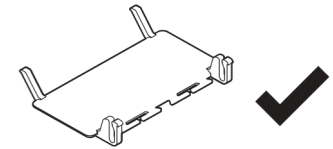

3. Place the front teeth of the shelf into the front rail of the desk. Click shelf into place by pushing upwards firmly on the rear of the shelf.

Side View

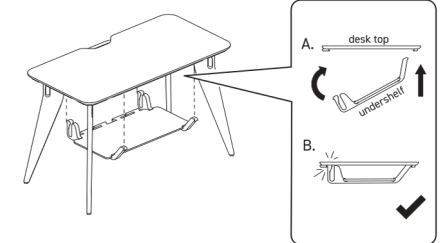

Save time.

Assemble & disassemble in seconds with no tools.



Save space.

Goes anywhere. Packs flat under 2" thick. Flat-Pack*



Save money.

Don't pay for assembly & keep your furniture forever.



Save Earth.

Circular design with eco-materials.

Wall Cleat Installation

1. Using the screws provided, install the Cleat on your wall in a l ooccaattioonn yyouu ddeessirree. . BBee ssuuree thhee sscrrreewss stud or drywall anchors rated for 100 LBS or more.

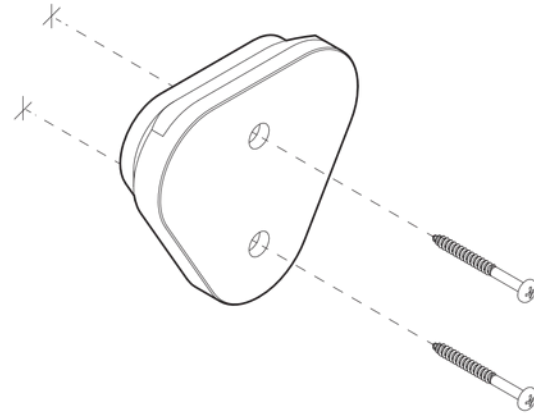

2. After the Cleat is mounted securely on your wall, you may hang your Hoek fFurniture.

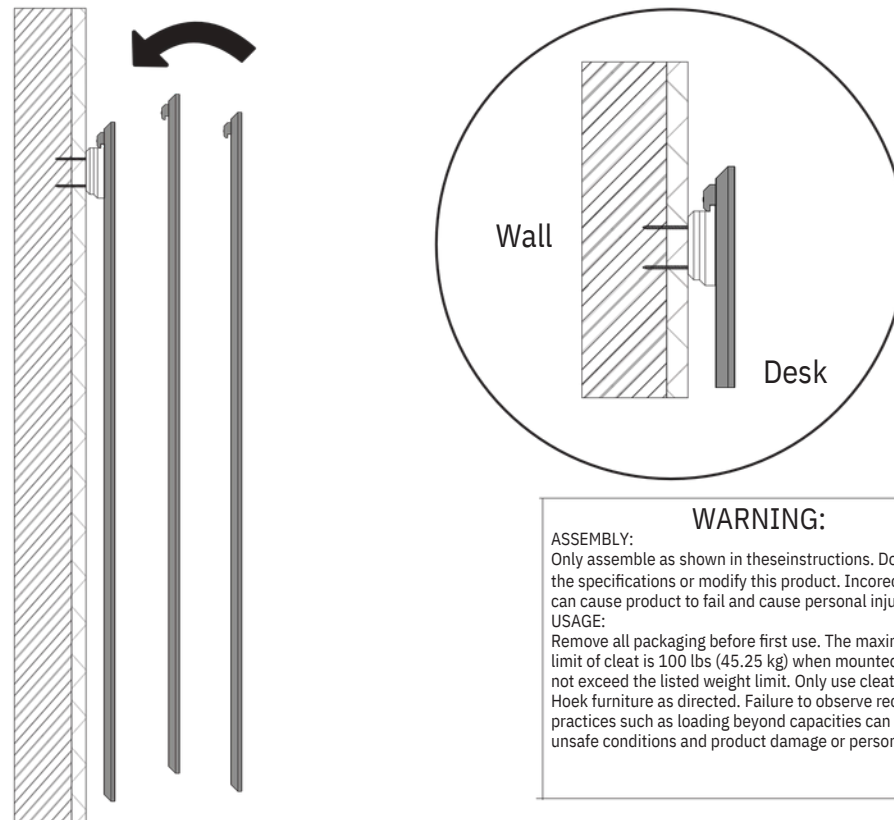

WARNING:
ASSEMBLY:
Only assemble as shown in these instructions. Do not change the specifications or modify this product. Incorrect assembly can cause product to fail and cause personal injury.
USAGE:
Remove all packaging before first use. The maximum weight limit of cleat is 100 lbs (45.25 kg) when mounted correctly. Do not exceed the listed weight limit. Only use cleat for storing Hoek furniture as directed. Failure to observe recommended practices such as loading beyond capacities can result in unsafe conditions and product damage or personal injury.